

Compression Tap Connector H-Shaped - Cu 6-10/6-10 mm²

for DIN 48201 compliant copper cables.
For cable taps and earth grid ring mains.

Sector-shaped conductors must be rounded with round-forming dies.

Material:

■ Cu

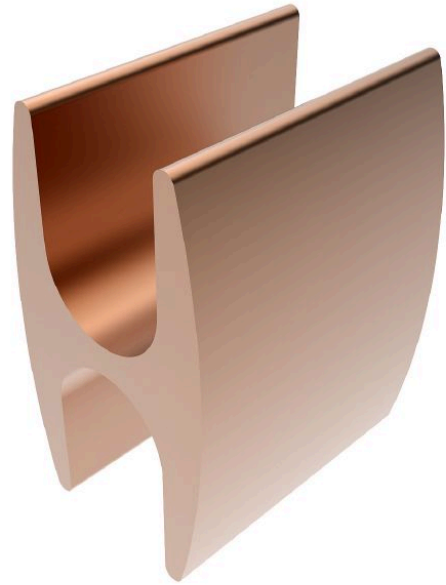

Picture may vary.

Technical Data

Type		H-Shaped
Article no.		301 335 335
Cross section of main conductor	(mm ²)	6 - 10
Cross section of tap conductor	(mm ²)	6 - 10
Diameter main conductor	(mm)	2,8 - 4,1
Diameter tap-conductor	(mm)	2,8 - 4,1
Code number		10 P0
Number of compressions x compression width	(mm)	2 x 5 / -
Surface		uncoated

Dimensions

Dimension B	b (mm)	8
Dimension L	(mm)	14