

Compression Tap Connector H-Shaped - Cu 25/6-10 mm²

for DIN 48201 compliant copper cables.
For cable taps and earth grid ring mains.

Sector-shaped conductors must be rounded with round-forming dies.

Material:

■ Cu

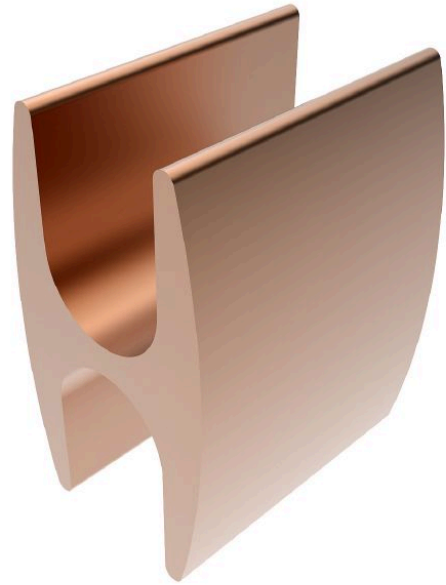

Picture may vary.

Technical Data

Type	H-Shaped	
Article no.	301 335 338	
Cross section of main conductor	(mm ²)	25
Cross section of tap conductor	(mm ²)	6 - 10
Diameter main conductor	(mm)	6,3
Diameter tap-conductor	(mm)	2,8 - 4,1
Code number	18 P0	
Number of compressions x compression width	(mm)	2 x 5 / -
Surface	uncoated	

Dimensions

Dimension B	b (mm)	12
Dimension L	(mm)	18