

Compression Tap Connector H-Shaped - Cu 50/50 mm²

for DIN 48201 compliant copper cables.
For cable taps and earth grid ring mains.

Sector-shaped conductors must be rounded with round-forming dies.

Material:

■ Cu

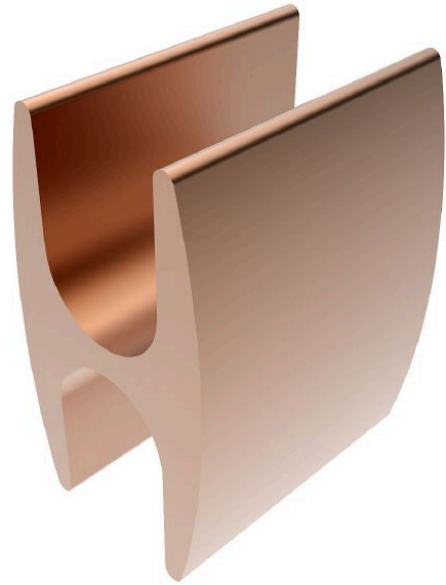

Picture may vary.

Technical Data

Type	H-Shaped	
Article no.	301 335 344	
Cross section of main conductor	(mm ²)	50
Cross section of tap conductor	(mm ²)	50
Diameter main conductor	(mm)	9
Diameter tap-conductor	(mm)	9
Code number	22 R	
Number of compressions x compression width	(mm)	3 x 5 / 1 x 28
Surface	uncoated	

Dimensions

Dimension B	b (mm)	15
Dimension L	(mm)	28