

Compression Tap Connector H-Shaped - Cu 120/120 mm²

for DIN 48201 compliant copper cables.
For cable taps and earth grid ring mains.

Sector-shaped conductors must be rounded with round-forming dies.

Material:

■ Cu

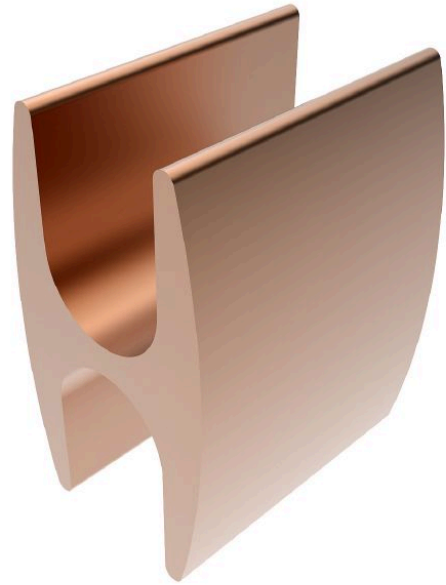

Picture may vary.

Technical Data

| Type | H-Shaped | |
|--|--------------------|------------|
| Article no. | 301 335 347 | |
| Cross section of main conductor | (mm ²) | 120 |
| Cross section of tap conductor | (mm ²) | 120 |
| Diameter main conductor | (mm) | 14 |
| Diameter tap-conductor | (mm) | 14 |
| Code number | 32 R | |
| Number of compressions x compression width | (mm) | - / 1 x 25 |
| Surface | uncoated | |

Dimensions

| | | |
|-------------|--------|----|
| Dimension B | b (mm) | 24 |
| Dimension L | (mm) | 25 |