

# Earthing and Short-Circuit Device for CONNEX Sockets Size 6 / 6-S

This device is used to earth and short circuit equipment fitted with CONNEX sockets size 6 / 6-S (e. g. switchgear, transformers etc.).

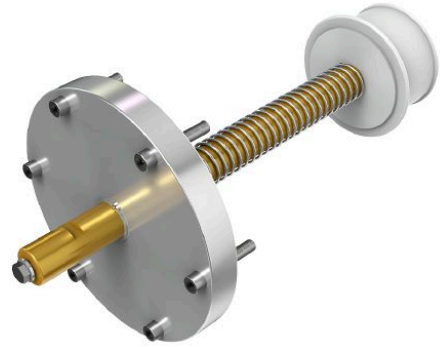

*Picture may vary.*

## Technical Data

<b>Article no.</b>	<b>827 086 006</b>
<b>Size</b>	6, 6-S
<b>Working place</b>	outdoor and indoor
<b>Environment temperature</b>	(°C) -25°C up to 50°C

## Dimensions

<b>Length outside socket</b>	(mm)	134
<b>Pitch circle diameter</b>	(mm)	245
<b>Connection thread</b>		1 x M12